



INSTALLATION MANUAL

SkyBox Hybrid



With great power
comes great
responsibility.



FIND THE RIGHT SECTION

Contents

Transporting	5
Warnings	6
Safety	8
What's included	9
Tools required	10
Dimensions and Clearance	12
Overview	13
Components	14
Getting ready to Transport	18
Positioning and Ventilation	19
Installing the SkyBox cabinet	20
Battery Interface BSL Battery	21
Cable connections TOP view down	22
Battery Interface Pylontech Battery	23
Installing the batteries	24
Cable connections TOP view down	25
Cable connection troubleshooting	26
BSL Battery + DIP Switch settings	27
Optimal connection example	28
Adding solar panels	29
Hardwiring the SkyBox	33
Adding a generator	34
Commissioning	35
Startup procedure	36
Shutdown procedure	38
Monitoring	40
FAQ's	41
Datasheet	42
Contact	44
Safety Data Sheet	45

TIME TO UP AND GO

Transporting



**Weight 250kgs -
270kgs approx.
without batteries**

Your SkyBox comes preprogrammed and prewired, ready to go. It ships out securely strapped on a pallet in the off position to the destination discussed.

Weight ranges from 250 - 270kg approximately excluding batteries—depending on parts used, batteries and other components available or other arrangements discussed with the SkyBox engineers in the pre-build stage.*

SkyBox should always be turned off properly before being moved and transported. Failing to power down may damage the SkyBox and components and cause property damage/fire.

SkyBox is extremely heavy; we do not recommend moving or attempting to lift the SkyBox without suitable lifting machinery to prevent personal injury and damage to the SkyBox. Incorrectly transporting and moving the SkyBox may void the warranty.

Once installed, a qualified electrician may remove batteries as a last resort and must be cautiously handled. Removal of any components/parts without contacting Sky Energy first may cause severe injury and damage to the system and void the warranty.

We recommend using a forklift if applicable. However, these are also suitable:

- Forklift - Recommended.
- Hand trolley.
- Pallet jack.
- Other specialised lifting tools.

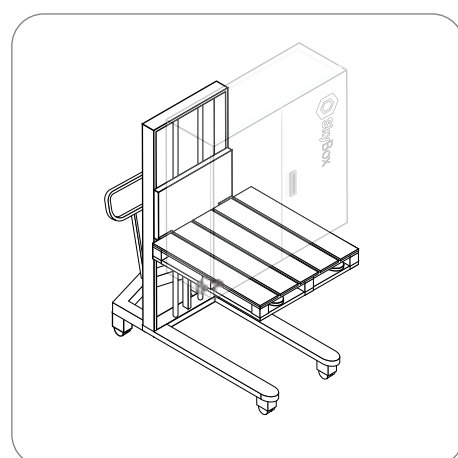
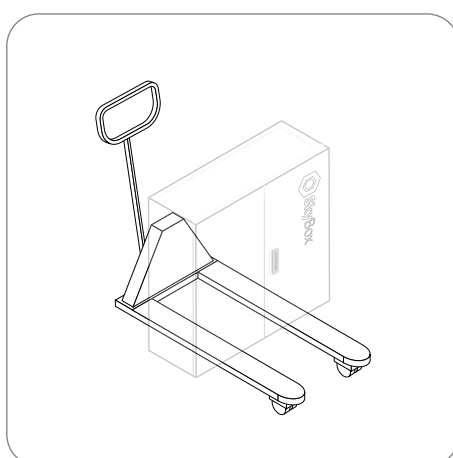
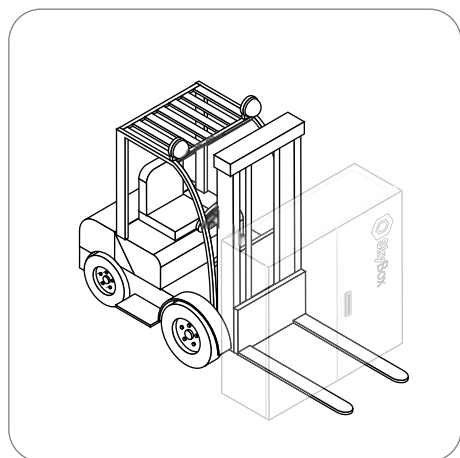

*Weight, parts and components may vary depending on stock availability and global supply.

IMPORTANT

Caution/Danger



The SkyBox is heavy. Use suitable lifting equipment to manoeuvre the battery units into position. A licensed electrician must install the SkyBox.

IMPORTANT

Warnings

- After transporting SkyBox, Check all terminals are tight and have a good connection before use.
- Ensure SkyBox is earthed and installed according to your region's electrical standards.
- When choosing a location for your SkyBox, ensure it is at least 1.5M away from any gas connection or ignition source.
- You must install the SkyBox to your region's electrical standards and battery code.
- Keep the SkyBox away from flooding/ water and long term direct sunlight.

WARNING

Lithium Battery hazard

Fire

In the case of fire, immediately evacuate the area and call emergency services (000 in Australia). Keep a dry agent fire extinguisher readily available, and DO NOT use water to extinguish a battery fire. Beware: battery fires may produce toxic gas.

Important Note

Sky Energy provide an SDS document with each SkyBox system. You can also find an electronic SDS document online at www.skyenergy.com.au/skybox.

Damaged battery

Do not use a damaged battery. Please dispose of lithium batteries at an appropriate recycling centre. Please contact Sky Energy should you require more information or guidance.

For further safety information, please refer to the SDS (Safety Data Sheet) document.

IMPORTANT

Safety

! **WARNING:** Any works inside the SkyBox are strictly undertaken by a qualified electrician only. Installation of the SkyBox must be carried out by a licensed electrician.

! All wiring diagrams and written instructions are provided as a guide only. Making sure installation is compliant and adheres to appropriate standards is the sole responsibility of the installer.

Please refer to the following relevant standard when installing any SkyBox product:

AS/NZS 3000:2018	Wiring rules
AS/NZS 5033:2014 (amdt 1&2)	Installation and safety requirements for solar, photovoltaic (PV) arrays
AS/NZS 4509.2:2012	Design of stand-alone power systems
AS/NZS 1170.2:2011	Structural design actions – Wind actions
AS/NZS1768:2007	Lightning protection
AS/NZS 3008.1.1:2017	Electrical installations – Selection of cables

! A qualified electrician who has thoroughly read and understood the operation manual and all hazards and dangers involved should go ahead with the installation of the SkyBox.

! **WARNING:** Do not attempt to charge the lithium batteries provided with this system with any charger device (other than the SkyBox). **DO NOT** connect any devices directly to the DC battery bus. Any attempts to do so will void the warranty.

This installation manual covers the SkyBox Hybrid model.

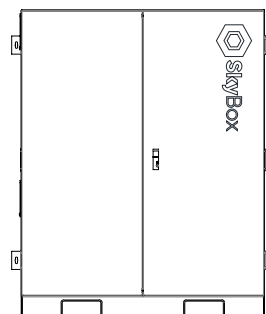

Sky Energy is always trying to better its products; as such, the installation manual and its content are subject to change at any time without notice. To ensure you have the most up-to-date manual, we advise you to visit www.skyenergy.com.au and download the relevant documentation.

BITS AND PIECES

What is included with SkyBox



WHAT YOU GET IN THE DELIVERY

- SkyBox
- Solar Panels (If Solar option is selected)
- Batteries (if the Battery option is selected)



WHAT YOU DON'T GET, BUT MIGHT NEED

- Electrical Cables – DC and AC
- Conduits and fittings
- Screws and fixings
- MC4 Connectors
- MC4 Branch Connectors
- Dektites
- Silicone and sealants
- Cat 5 or Figure 8 Cable (You will need this if you are connecting a generator autostart)
- Earth Stake



REQUIRED SKILLS

- Qualified Electrician
- Solar panel installation experience (If buying with solar panels)

INSTALLING THE RIGHT WAY

Tools required

To make installing the SkyBox as quick and straightforward as possible, please ensure you have the correct tools before starting.

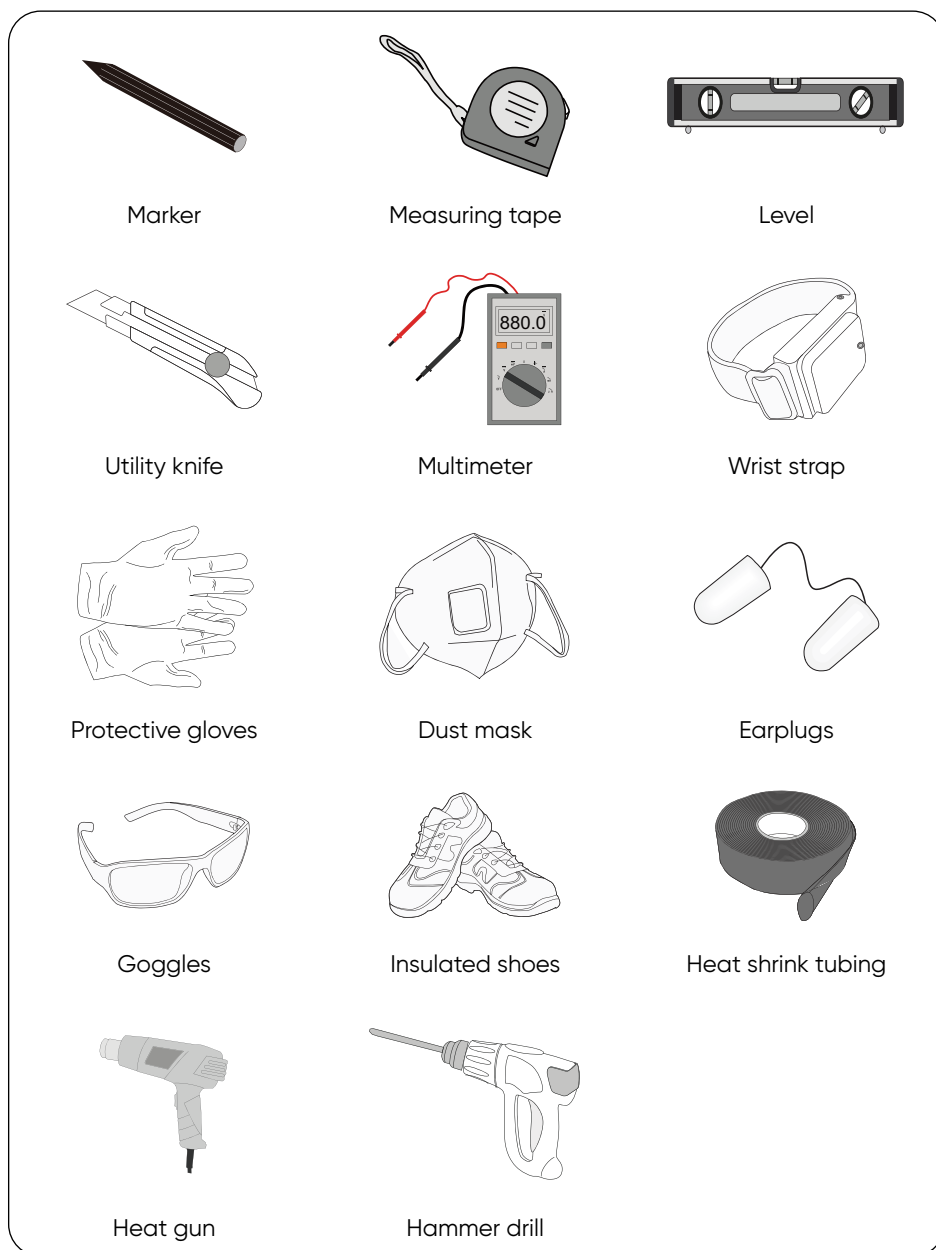

INSTALLING THE RIGHT WAY

Tools required



Rubber mallet



Electric screwdriver

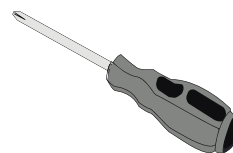

Phillips screwdriver

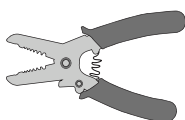

Wire stripper

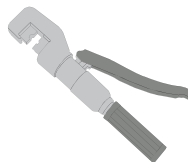

Hydraulic plier

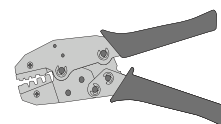

Crimping tool

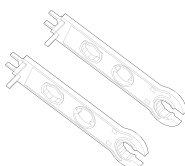

Wrench

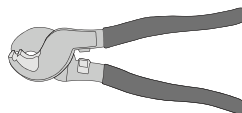

Wire clipper

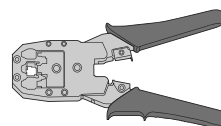

RJ45 Crimping tool

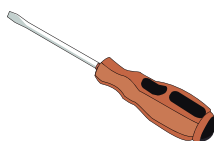

Flat head screwdriver



Torx screwdriver

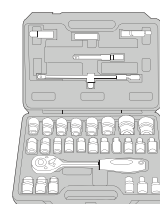

Socket wrench

ITS NOT THE SIZE THAT MATTERS

Dimensions & Clearance

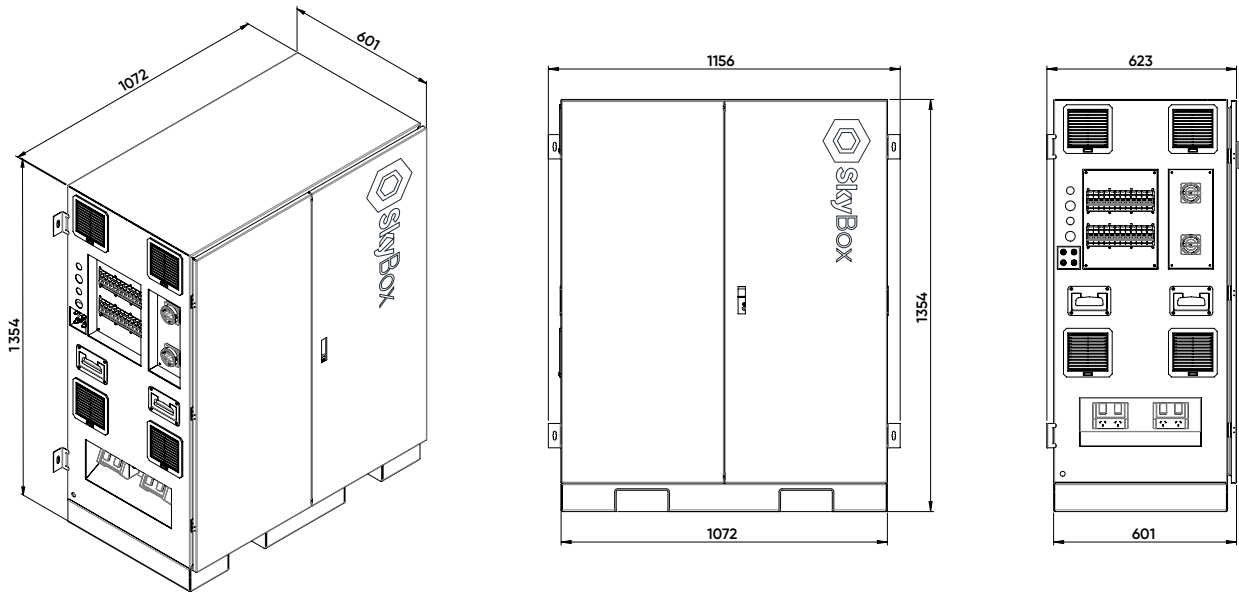

*Sizing may vary depending on stock availability and global supply. Orientation of inlets may vary.

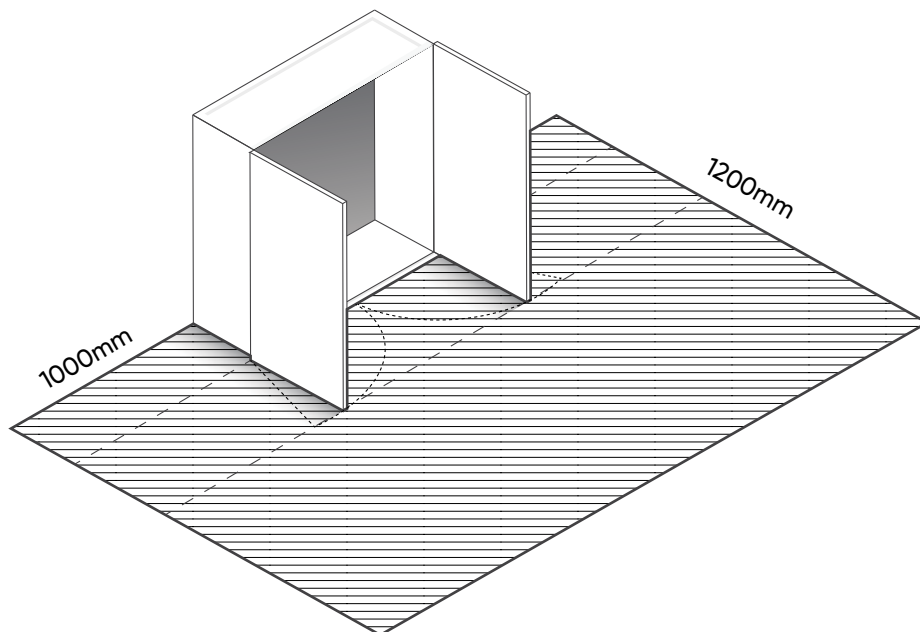

CREATE YOUR OWN POWER GRID

Overview

SkyBox gives everyone freedom and independence from the power grid.

Acting as a central 'brain,' the SkyBox manages incoming power from your solar, or generators.

Balancing these power sources and storing excess energy in the internal batteries, SkyBox creates a reliable electricity supply.

ACCESSING THE INTERNALS

Components

Opening the SkyBox

A key is required to access the internal section of the SkyBox. Now that the door has been unlocked lift the handle toward you, then keep raising it to the right until it pops out. Use the handle to pull open the door as required. The left door can now be opened with ease.

We strongly recommend keeping the SkyBox locked at all times.

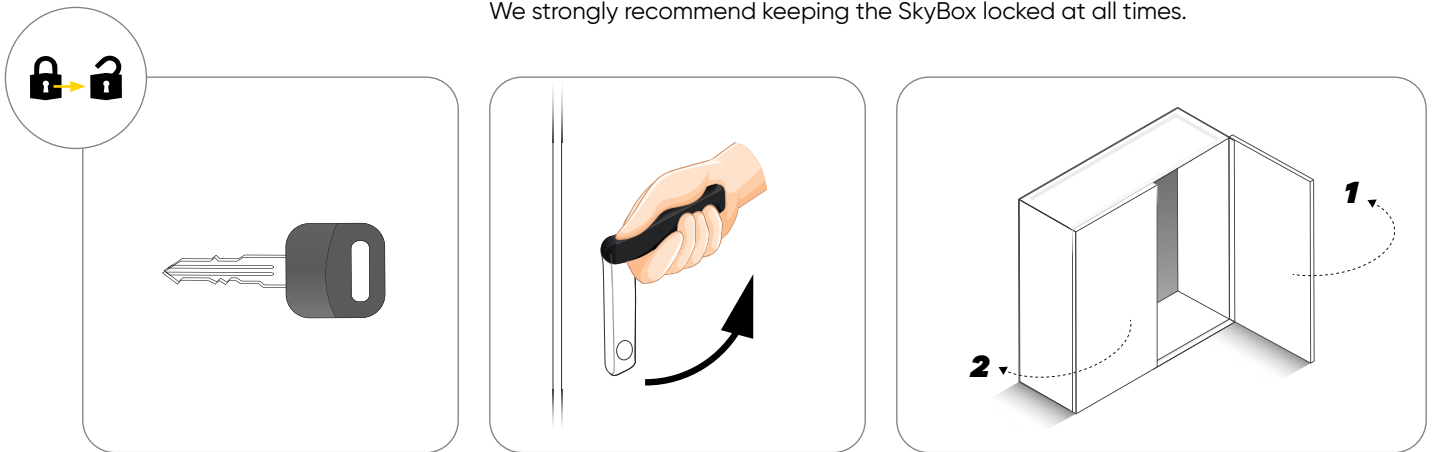

Closing the SkyBox

To close and lock the SkyBox, first, make sure the left door is shut. Close the right door and use the handle to push down clockwise until the handle pops into place. Use the key to lock the SkyBox.

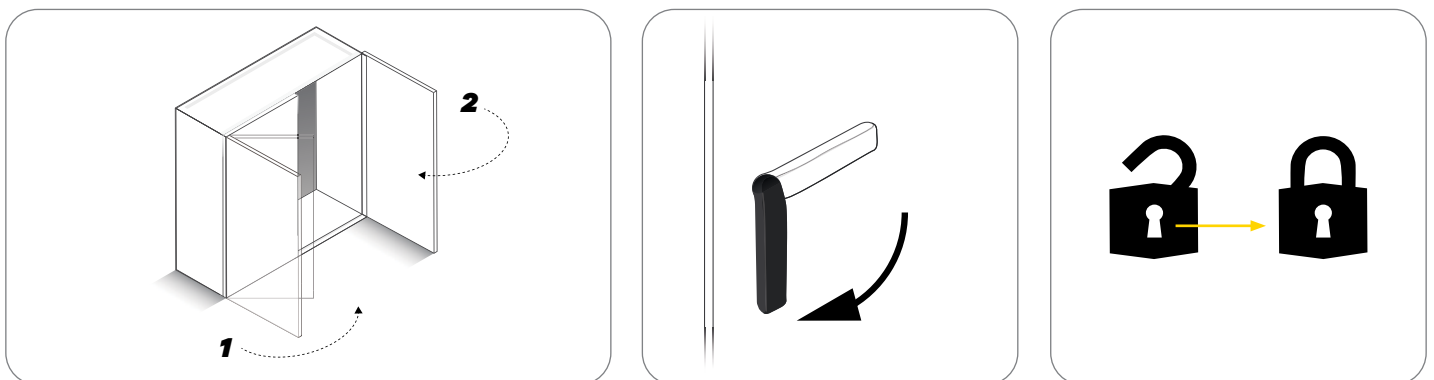

If you have lost your set of keys and cannot access your SkyBox, please contact our team at **1300 787 488**. We will send you a replacement pair for a small fee.

INTRODUCING THE SKYBOX

Components (outside)

Key

- 01 Key Handle
- 02 Key Hole



INTRODUCING THE SKYBOX

Components (side)

Key

- 01 Switchboard
- 02 MC4s
- 03 PV Array Isolators
- 04 AC Cable Penetrations
- 05 Extraction fans
- 06 Inlet fan and vent
- 07 Earthing cable penetration
- 08 GPO's

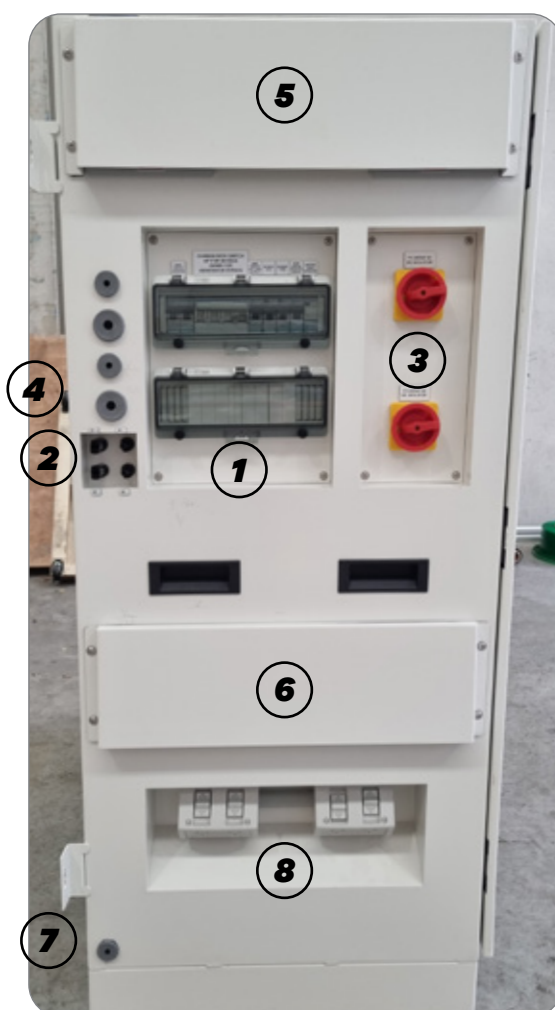

INTRODUCING THE SKYBOX

Components (inside)

Key

- 01 Inverter
- 02 Battery rack
- 03 Extraction fans
- 04 Inlet fan and vent
- 05 DC isolator
- 06 Thermostat

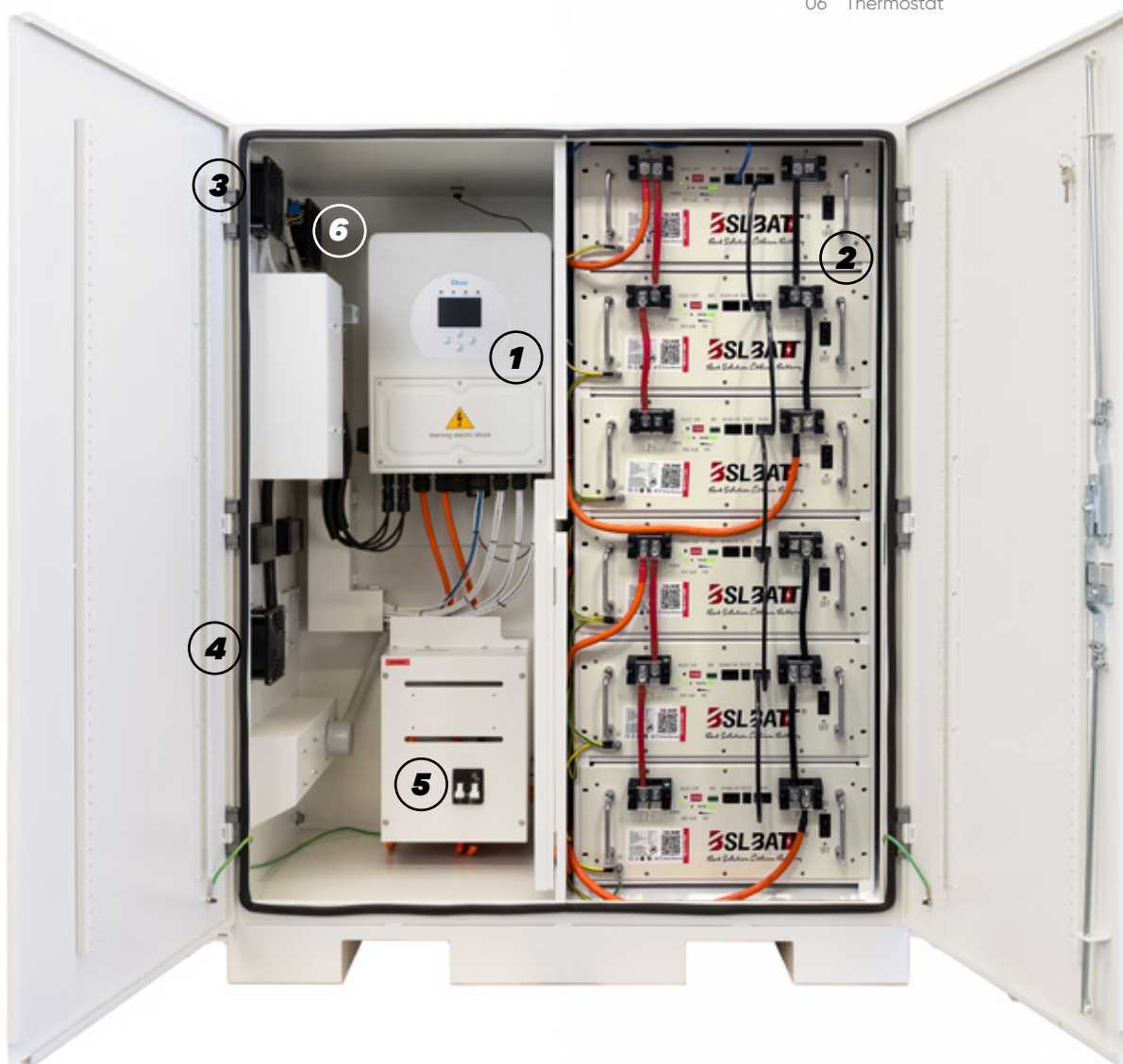

*General layout pictured. Layout may vary.

BEFORE YOU GO

Getting ready to transport



Warning

Never ship the skybox with batteries installed.

Warning

Remove batteries before transporting them, and always ship in secure packaging to protect them from damage.

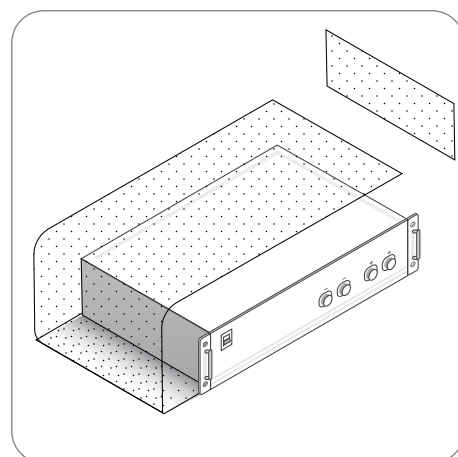
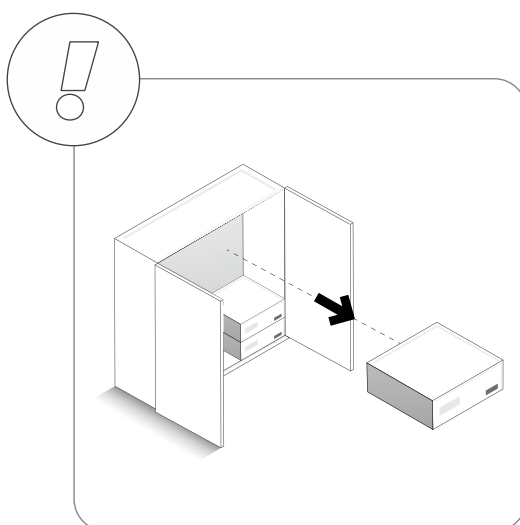

LOCATION, LOCATION, LOCATION

Positioning and Ventilation

Designed, tested, and built to IP54 standards to withstand all weather conditions, SkyBox is a freestanding system that can be installed indoors or outdoors.

Prebuilt fans and vents are situated on the left hand side. These vents should be unconcealed and have the specified clearance when the SkyBox is sitting in its installation position.

It is crucial to leave enough clearance on each side of the SkyBox to allow optimal/maximise airflow to and from the vents. Any blocking will leave the system open to overheating, which could cause irreversible malfunctions/damage. Following these instructions will keep the internal components of the SkyBox working optimally for longer.

The optimal and recommended placement for the SkyBox is in a shaded area away from direct sunlight. Do not place in a location that experiences long term direct sunlight.

If combined with solar panels, we recommend placing the SkyBox as close to the array to minimise voltage drop/power loss.

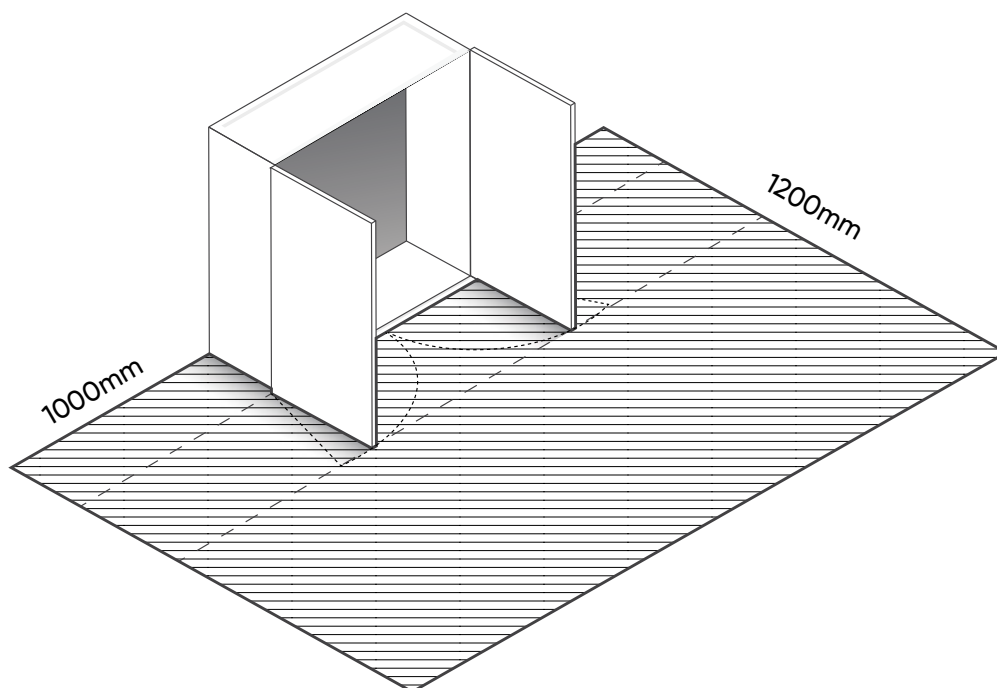

THE PERFECT PLACE

Installing the SkyBox cabinet

1. Choose the desired space for the SkyBox and clear the surrounding area.
2. Place the SkyBox on a stable, even surface. Remember to use proper lifting equipment to move into place.
3.  Secure and fasten the SkyBox to the wall with fastening eyelets. Screws not supplied.

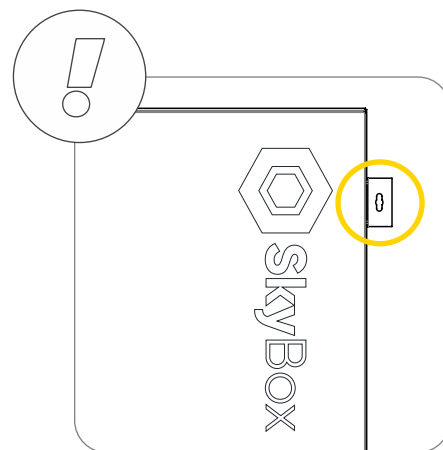
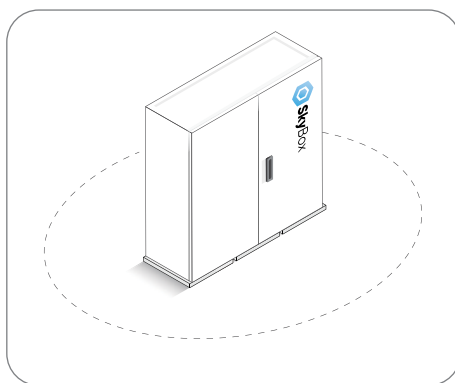
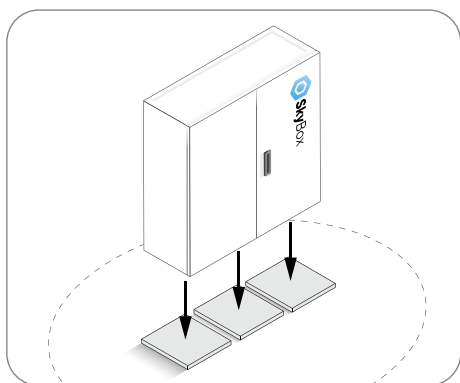

GETTING TO KNOW YOUR BATTERY

Battery interface

SL3ATT
GUIDE

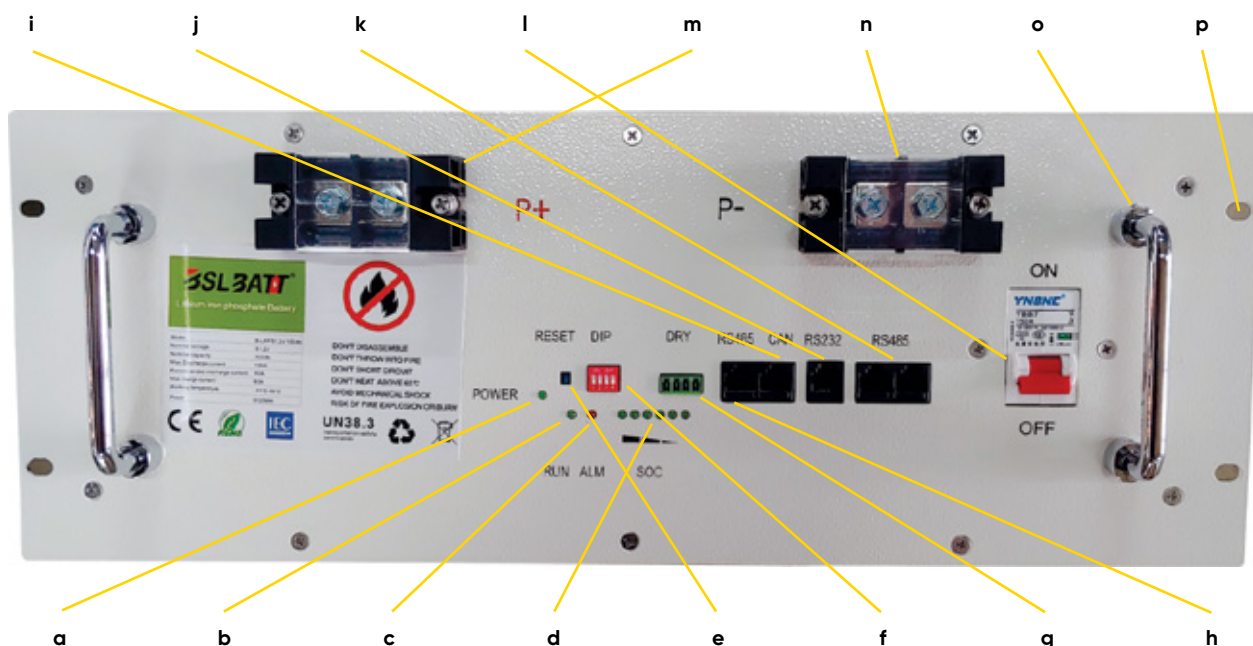

- a) Power indicator light
- b) Run light (battery activity)
- c) Alarm indicator light
- d) State of charge indicator lights
- e) Reset switch (BMS Power button)
- f) Dip switches for parallel connection
- g) Dry Contacts (Unused)
- h) RS485 Left port (Unused)
- i) CAN Port (Port 2)
- j) RS232 Port (Unused)
- k) RS485 Battery Link Ports (Ports 4 & 5)
- l) Circuit breaker (terminal power)
- m) Positive terminal
- n) Negative terminal
- o) Carry handles
- p) Mounting holes

GETTING THE BATTERIES TO WORK TOGETHER

Cable connections TOP view down

BSL3ATT[®]
GUIDE

SkyBox - BSL

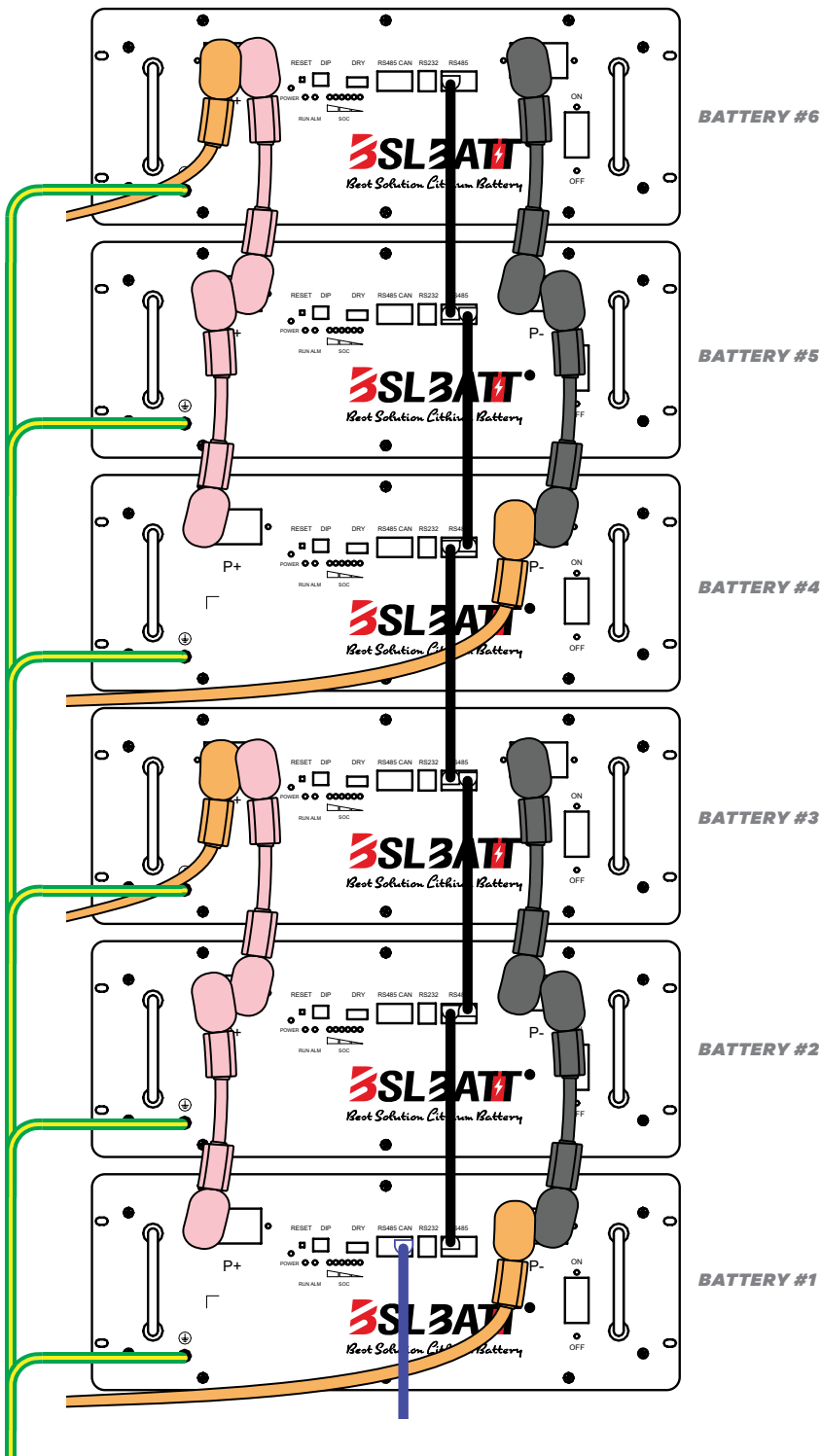

DIP Switch Settings

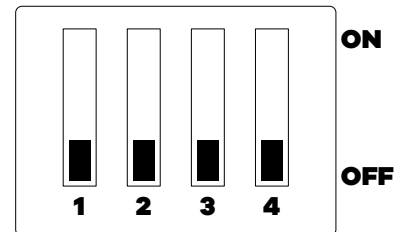

Battery #1	ON	OFF	OFF	OFF
Battery #2	OFF	ON	OFF	OFF
Battery #3	ON	ON	OFF	OFF
Battery #4	OFF	OFF	ON	OFF
Battery #5	ON	OFF	ON	OFF
Battery #6	OFF	ON	ON	OFF

GETTING TO KNOW YOUR BATTERY

Battery interface

PYLONTECH
GUIDE

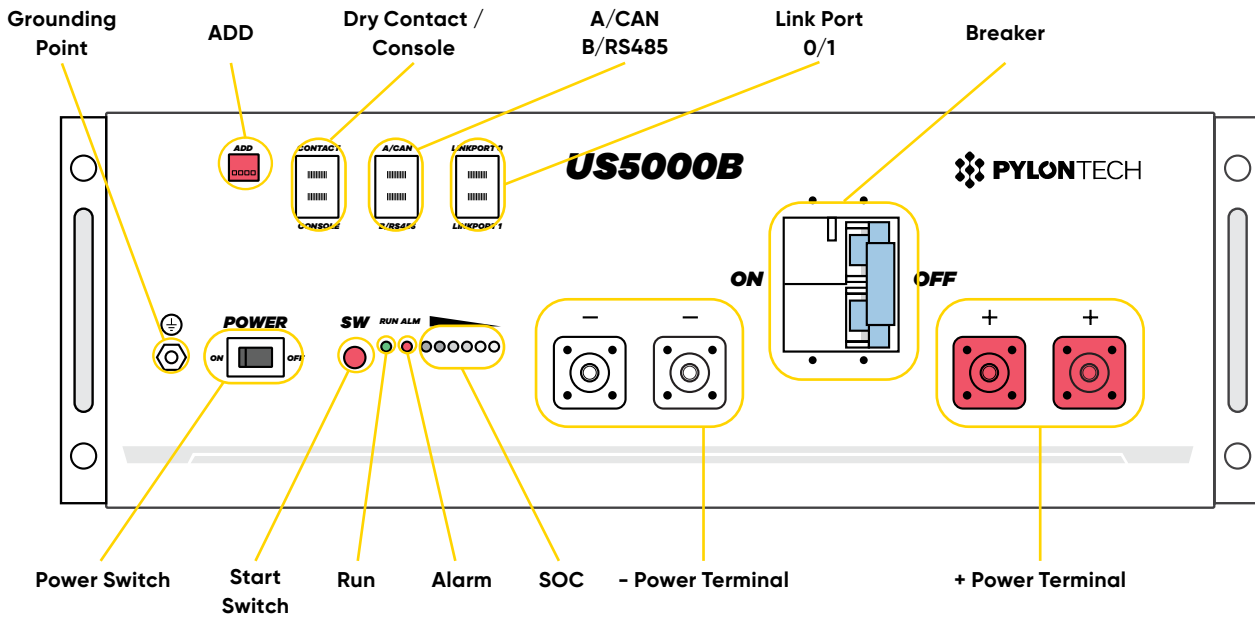

Breaker (for US5000-B)

Parameter: type C, rated voltage 60V/DC, rated current 125A, Icu: 10kA.

Standard reference: UL1077, IEC60947-2.

ON: power terminals connect with battery.

OFF: power terminals disconnect with battery.

Run

Green LED lighting to show the battery running status.

Alarm

Red LED flashing shows the battery has an alarm; lighting shows the battery is under protection.

SOC

Six green LEDs show the battery's current capacity.

Dip Switch (ADD)

DIP switches must remain in the off position.



Reminder

When breaker is released for protection, check the root cause of current surge and cable connection between battery and inverter first. Then try to connect again.

Power Switch

ON: ready to turn on.

OFF: power off. For storage or shipping.

Start Switch

Turn on: press more than 0.5s to start the battery.

Turn off: press more than 0.5 to turn off the battery.

GET THE BATTERIES CONNECTED

Installing the batteries in the cabinet

PYLONTECH
GUIDE

1. Place the batteries into the SkyBox cabinet, and secure with screws provided in battery rack.

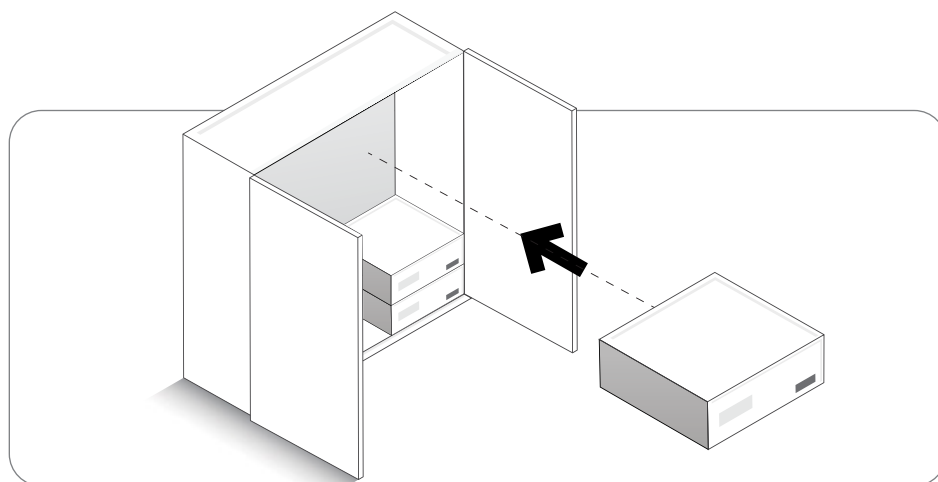

The hole on the bottom left hand side of cabinet is provided to run earth cable to earth rod if required.

2. Plugin the black and red cables onto the battery terminals. Ensure connections are tight.

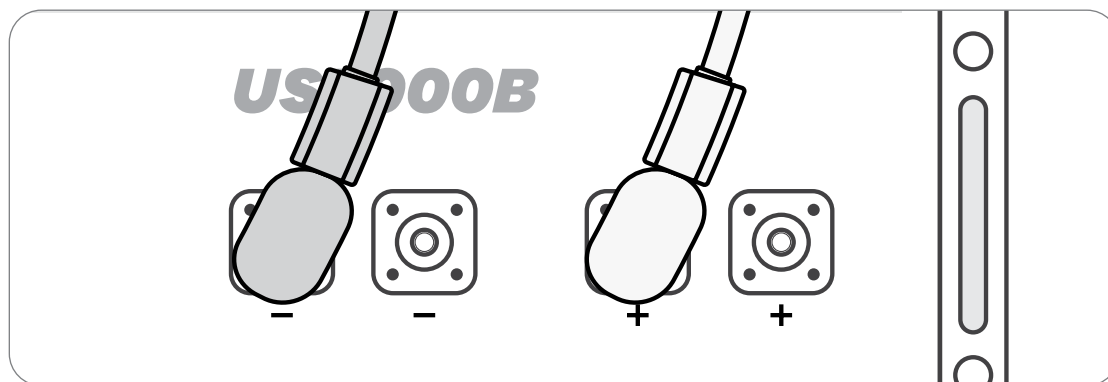

3. Plug inverter cable into A/CAN (Page 24).

GETTING THE BATTERIES TO WORK TOGETHER

Cable connections TOP view down

PYLONTECH
GUIDE

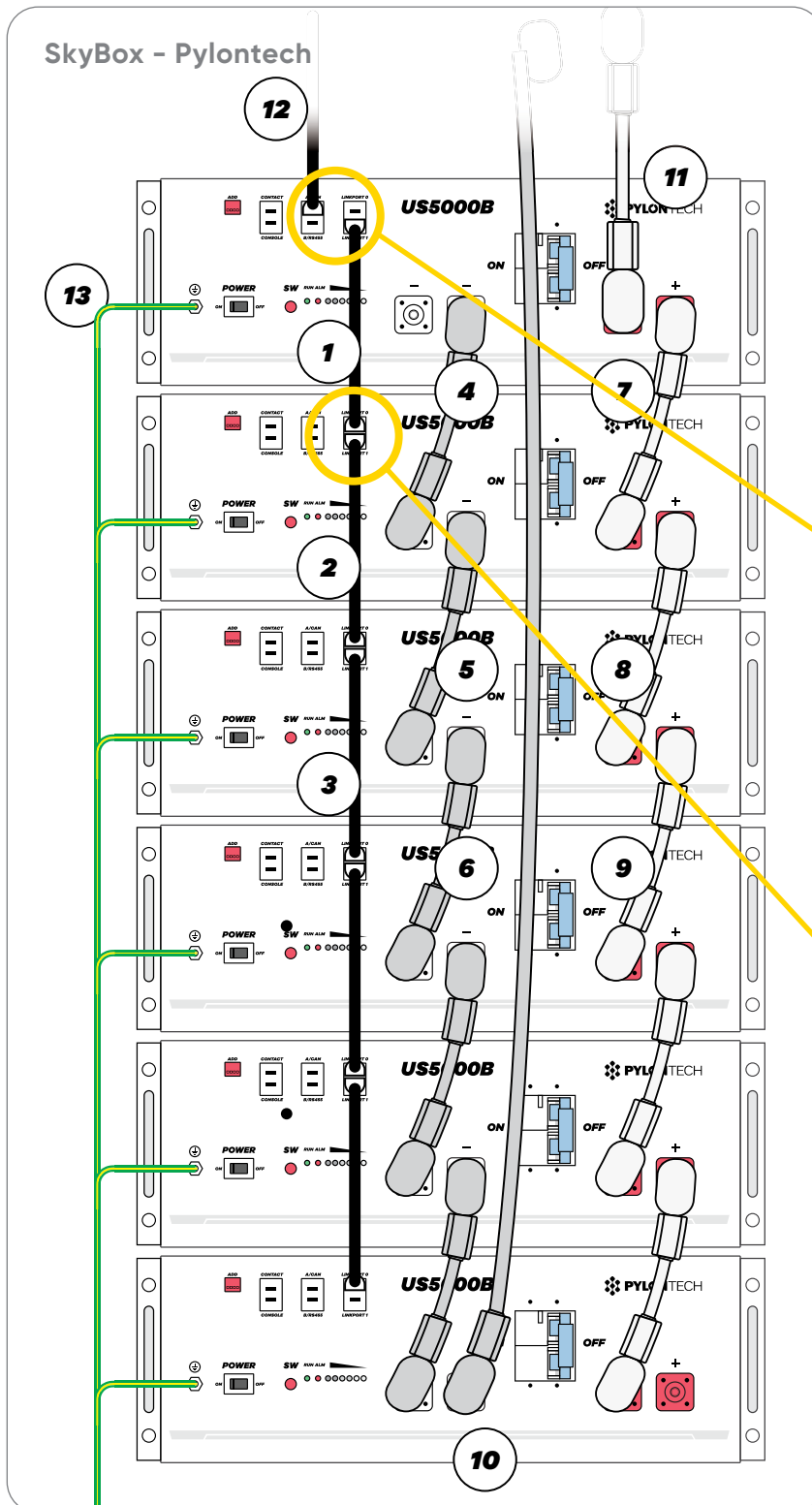

Connect the cables as shown below to suit the number of batteries you require.

SkyBox – 2 pairs of red and black cables return to inverter; each pair should be used for 4 batteries. Earth should be continuous to all batteries.

Connect the communication cable from battery 4 to battery 5 and continue up until battery 8.

13 – Earth Cables.

12 – From Inverter.

1, 2, 3 – Battery comms connections.

10, 11 – From Battery Breaker.

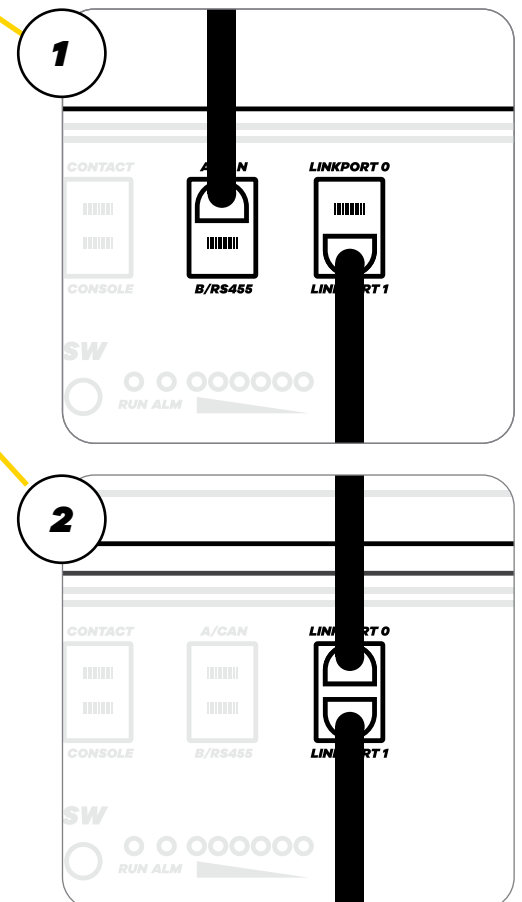

GETTING THE BATTERIES TO WORK TOGETHER

Cable connection troubleshooting

PYLONTECH
GUIDE

Troubleshooting

The most common mistake connecting the cables is starting from "Link Port 0", which is incorrect.

Please make sure the inverter cable is plugged into the "A/CAN" Port. Then connect batteries starting from "Link Port 1" to "Link Port 0" of the next battery unit and continue to alternate.

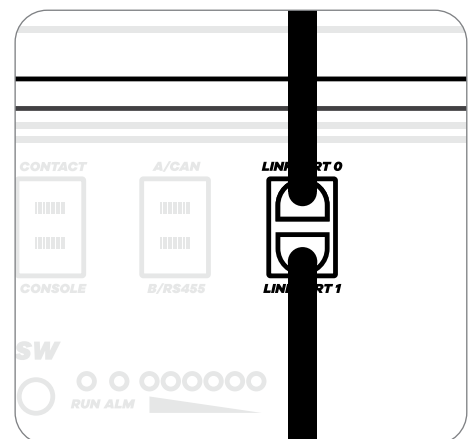
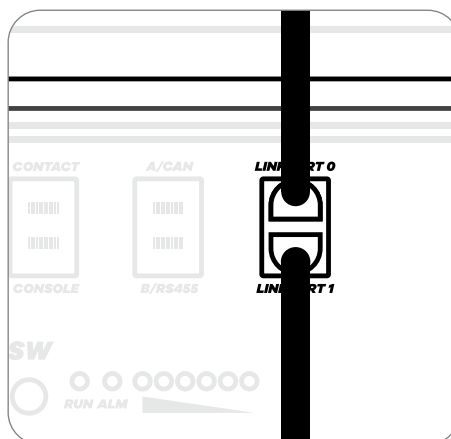
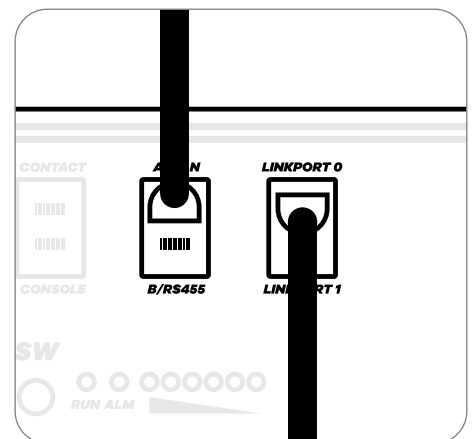
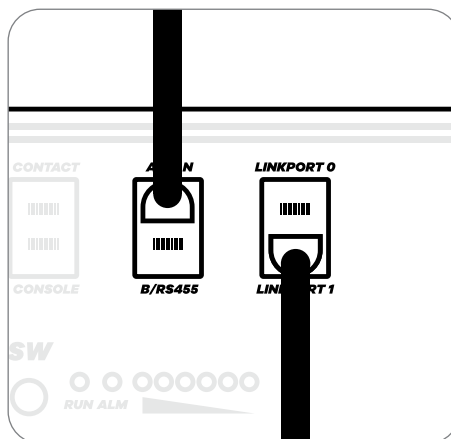

GETTING THE BATTERIES TO WORK TOGETHER

BSL Battery



Mastery battery comms cable connects to CAN port and then daisy chain links all battery's with the RS485 connection with emphasis on the dip switch settings from master to slave right hand batteries.

GETTING THE BATTERIES TO WORK TOGETHER

DIP Switch settings

Definition of the switch is as follows.

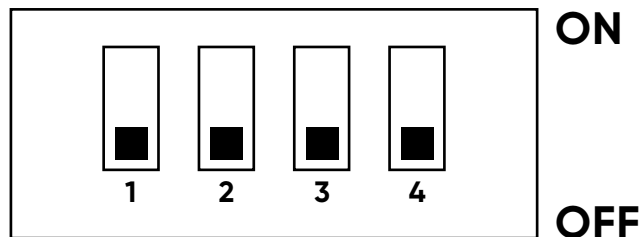

ADDRESS	DIP SWITCH POSITION				NOTE
	#1	#2	#3	#4	
0	ON	OFF	OFF	OFF	Stand-alone use
1	ON	OFF	OFF	OFF	Master Pack
2	OFF	ON	OFF	OFF	Auxiliary Pack1
3	ON	ON	OFF	OFF	Auxiliary Pack2
4	OFF	OFF	ON	OFF	Auxiliary Pack3
5	ON	OFF	ON	OFF	Auxiliary Pack4
6	OFF	ON	ON	OFF	Auxiliary Pack5
7	ON	ON	ON	OFF	Auxiliary Pack6
8	OFF	OFF	OFF	ON	Auxiliary Pack7
9	ON	OFF	OFF	ON	Auxiliary Pack8
10	OFF	ON	OFF	ON	Auxiliary Pack9
11	ON	ON	OFF	ON	Auxiliary Pack10
12	OFF	OFF	ON	ON	Auxiliary Pack11
13	ON	OFF	ON	ON	Auxiliary Pack12
14	OFF	ON	ON	ON	Auxiliary Pack13
15	ON	ON	ON	ON	Auxiliary Pack14

GETTING THE BATTERIES TO WORK TOGETHER

Optimal connection example

SL3AT
GUIDE

This is the optimal battery connection for balanced voltage across all battery's for equal charging.

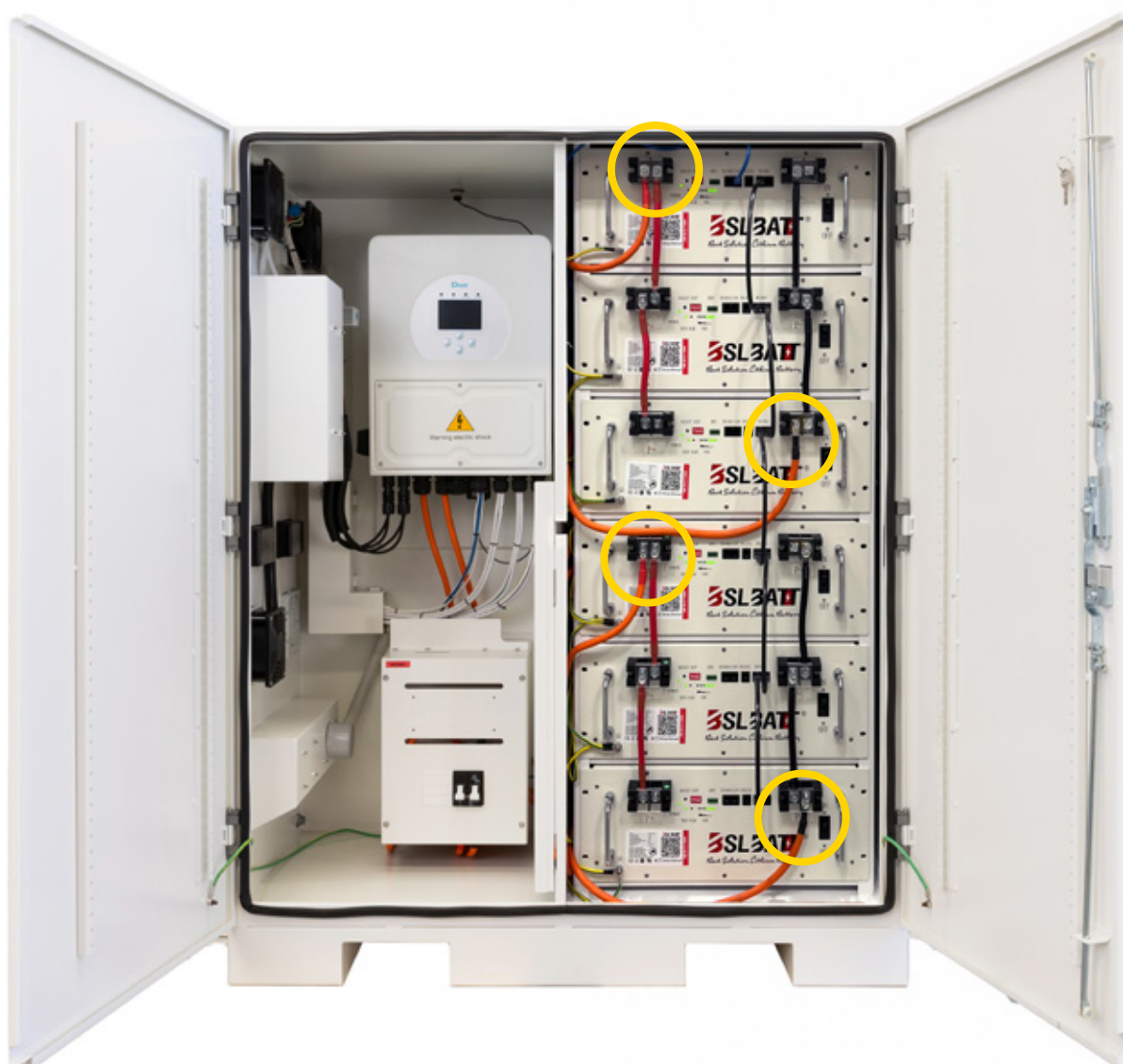

LET'S USE THAT SWEET ENERGY FROM THE SUN

Adding solar panels



Not installing panels? You can fast forward to page 31.



Warning

Solar panels start producing electricity as soon as they are exposed to sunlight.



Warning

Check the inverter rating before installing a PV array. If the voltage or current values on the PV array are above the inverter, it will damage the SkyBox system and void the warranty.

1. Electrical Calculations

It is essential to ensure the solar voltages and current do not exceed the maximum inputs allowed on the skybox solar controller.

When calculating maximum voltages and current, we use the method found in the Australian Standards (your country code may differ).

Look for **VOC** and **ISC** on the specification sticker of your chosen panel.

Model	Max PV Open Circuit Voltage	Max PV Short Circuit Current
5kW Hybrid SkyBox	500V	19.5A per tracker
8kW Hybrid SkyBox	500V	39A per tracker

Panel PV Calculations

VOC = Qty of panels (series) X VOC X 1.12

ISC = No. of parallel strings X ISC X 1.25

See section 5 for examples of how to calculate strings.

The way to determine the maximum allowed inputs is to check the solar input specs printed on the inside of the door.

2. Strings

A string is a set of panels connected with a positive and negative on either end to create a circuit. Before wiring up panels, a basic understanding of series and parallel series is recommended.

Most charge controllers allow for a higher current input which will require running parallel strings. When running a parallel string, there are a few essential points.

1. A parallel string must be the same amount of panels in each series string eg. 2 strings of 4 panels will work, but a string of 3 and 4 in parallel will NOT work
2. Each string in a parallel set can be a different orientation or angle. Eg. 5 panels on the east and 5 on the west in parallel will work.

3. Connecting the solar panels

LET'S USE THAT SWEET ENERGY FROM THE SUN

Adding solar panels

Once the solar panels have been installed and wired up, you will end up with a positive and a negative cable return to the SkyBox. Simply connect these to the supplied DC isolator. Each isolator on the Skybox Hybrid can take 500V and 50A, and each MC4 is rated to 39A.



LET'S USE THAT SWEET ENERGY FROM THE SUN

Adding solar panels

4. Earth

It is essential to earth the solar panel array back to the main earthing point in the SkyBox. The earth can be connected using the supplied earth lugs and continuously lopped between all lugs and brought back to the SkyBox. Feed the earth cable into the SkyBox and connect it to the main earth bar inside the switchboard.



LET'S USE THAT SWEET ENERGY FROM THE SUN

Adding solar panels



Warning

Solar panels start producing electricity as soon as they are exposed to sunlight.

5. Examples

Let's have a look at some potential string configurations and how they might be wired.

SkyBox Hybrid 5kW

20 x 415w (8.3kw) Solar Panels (VOC: 37.42V / ISC: 13.9)

Input Limit: 500V and 19.5A

$VOC = \text{Qty of panels (series)} \times VOC \times 1.12 = 11 \times 37.42 \times 1.12 = 419V$ (max 11 panels per string)

$\text{No. of parallel strings} \times ISC \times 1.25 = 1 \times 13.9 \times 1.25 = 17.4$

We can see here that 1 string is under both the VOC and ISC input limits, so we are safe to install 1 string of 11 on each tracker. If we were to parallel 2 strings, the current would become 34.8A which is over the 19.5A input current limit and thus we cannot parallel strings.

SkyBox Hybrid 8kW

28 x 440w (12.32kw) Solar Panels (VOC: 39.53V / ISC: 14.3)

Input Limit: 500V and 39A

$VOC = \text{Qty of panels (series)} \times VOC \times 1.12 = 11 \times 39.53 \times 1.12 = 487V$ (max 11 panels per string)

$\text{No. of parallel strings} \times ISC \times 1.25 = 2 \times 14.3 \times 1.25 = 35.75$

We can see here that paralleling a string is under both the VOC and ISC input limits, however we would be left with 11 panels paralleled with 3 panels, which is not okay. To fix, simply keep both parallels equal in terms of number and size of panels; 7 panels paralleled with another 7 panels. Using the above methods, we would calculate a VOC of 309.9V and an ISC of 35.75, both of which are below the limits and is now safe to install.

Note

Extra power produced above the inverter capabilities will be clipped by the inverter and not utilised.

FORMALLY PART OF THE SYSTEM

Hardwiring the SkyBox (Connecting to an A.C. load) (optional)



Not hardwiring?
You can plug straight
into the powerpoint.



Important

Please make sure that the SkyBox is turned OFF before opening the switchboard. Follow the Shutdown procedure if the SkyBox is turned on.

! Important - Please make sure that the SkyBox is turned OFF before opening the switchboard. Follow the shutdown procedure below if the SkyBox is turned ON.

1. Run the grid Active, Earth and Neutral to terminals 6, 7 and 8 respectively.
2. Run the EPS Circuit power Active and neutral to terminals 9 and 10 respectively

* Note that earth is not required, but terminal 10 is supplied to terminate into if needed.

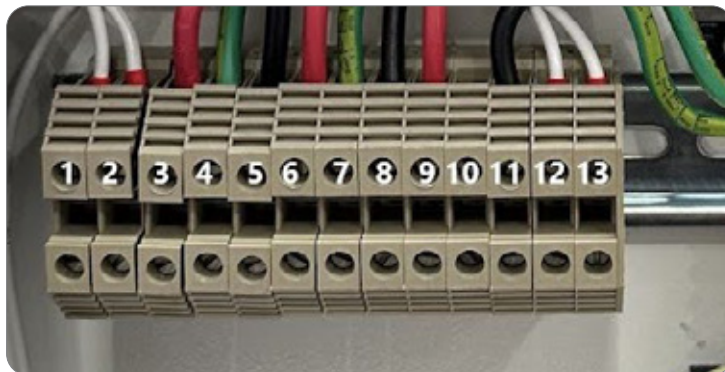

Terminal No.	Terminal Function
1	Generator Auto Start Contact - NO
2	Generator Auto Start Contact - COM
3	Generator Active
4	Generator Earth
5	Generator Neutral
6	Grid Supply Active
7	Grid Supply Earth
8	Grid Supply Neutral
9	EPS Active
10	EPS Earth (EARTH NOT REQUIRED - DO NOT CONNECT TO EARTH BAR)
11	EPS Neutral
12	CT (White)
13	CT (Black)
14	Fans to Thermostat

Earthing.

1. **!** Ensure earthing requirements meet the appropriate electrical standard for your region and country.

BACKUP WITH A GENERATOR

Adding a generator



Limitations

Electrician required.

Hardwire the generator into the 'Generator' terminals.

Run the Active, Earth and Neutral to terminals 3, 4 and 5 respectively.

*Note that the MEN of the generator will need to be removed.

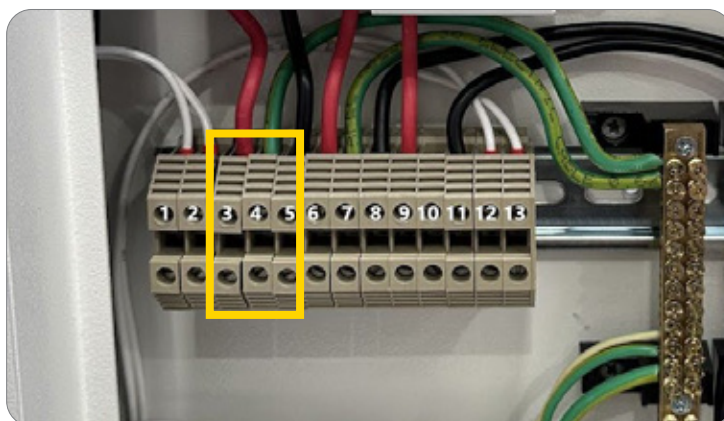

Auto start

You may configure the generator with a two-wire auto start. The auto-start terminals are located within the switchboard. Connect to terminals 1 and 2 -

*Note these terminals do not have polarity.

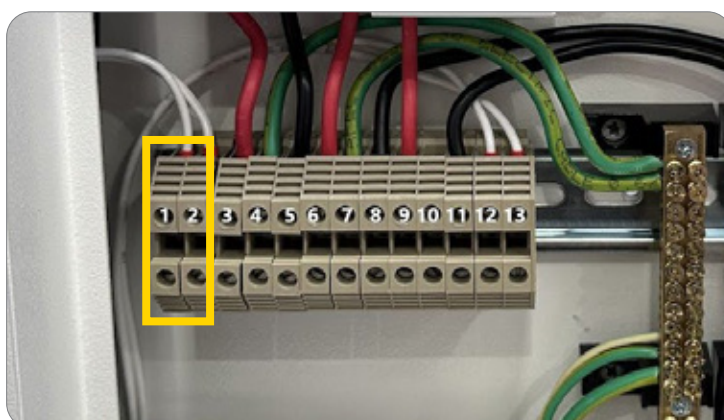

READY TO ROLL

Commissioning

Thorough commissioning and testing are done on all SkyBox models before they leave our headquarters. Your SkyBox will not leave our warehouse until it has been certified by our SkyBox technicians.

As with all systems, they are unique from the build to how their owners use them; this means slight changes to the parameter configuration are occasionally required. We strongly recommend a qualified technician to do this. If unsure, please contact our SkyBox technicians on **1300 787 488**.

TIME TO GET IT GOING

Start-up procedure

1. Turn on battery DC isolator.
2. Turn on the battery bank by following the "Start Up" procedure in Battery Connections - Next Page
3. Switch on the Deye inverter by pressing the On/Off button (located on the left side of the case)



4. Ensure that the rotating switch on Deye inverter (located on the left side of the case) is rotated clockwise to ON position.
5. Turn on the Circuit Breaker Grid Supply
6. Turn on the main switch EPS
7. If generator installed, turn on Main Switch (Generator)
8. Turn on the PV isolators

TIME TO GET IT GOING

Pylontech

Start-up Procedure

Step 1



Troubleshooting

If by any chance only 1 or 2 lights turn on but not the rest, please check all comms cabling and restart.

Any change you make, turn on/shut down and check cabling.

For any other issues, please call us on 1300 787 488

Power on

Double-check all the power cables and communication cables.

1. Switch ON all modules' breakers first.
2. Switch on all the battery modules. The one with the BMS cable plugged into the CAN port is the master, the other modules are the slaves.

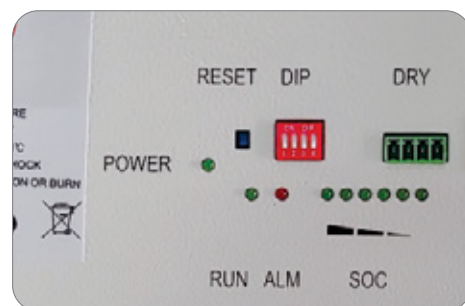
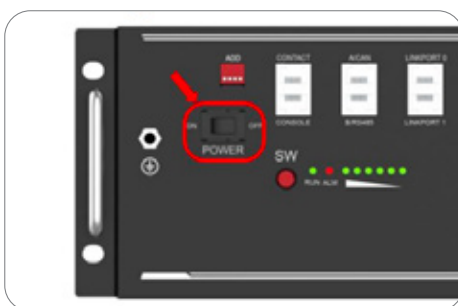

3. Press the red SW button on Pylontech, or the reset button on BSL button of the master battery to power on; all the battery LED lights will turn on automatically one by one from the Master Battery.

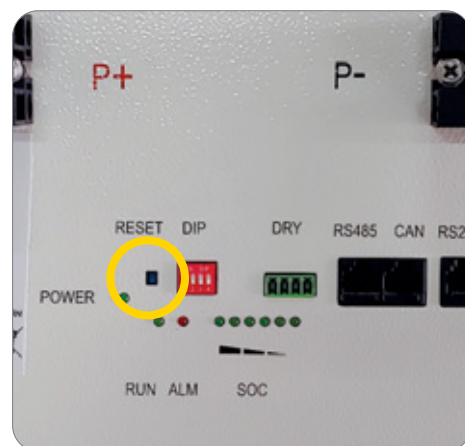
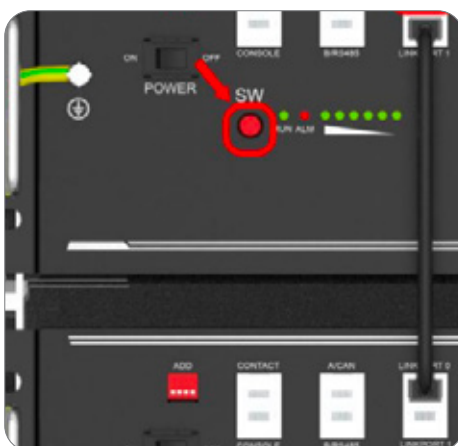

POWERING DOWN

Shut down procedure

Power off



1. AC OFF – turn off all of the switchboard breakers



2. PV Isolators OFF



3. Inverter PV Isolator off



4. Inverter off – ON/OFF button on the left hand side of the inverter

POWERING DOWN

Shut down procedure continued...

5. Battery system DC Isolator OFF



6. Follow battery shutdown procedure in battery removal

SEE WHAT YOUR SYSTEM IS DOING

Setting up system monitoring and viewing system performance

1. Download Deye Cloud App (available on the iOS App Store and the Google Play Store)
 2. Register an account and follow the steps
 3. Login with new account
 4. Create a plant (drop down menu top right) and enter the required information and confirm creation
- *System type is storage system
5. A pop will appear to add the data logger, click 'Add now' and scan the QR code on the dongle at the bottom of the inverter (pictured below)
 6. Once added, WiFi is required for live updates
 7. Select Device at the bottom of the screen
 8. Select Logger at the top of the screen
 9. Select Wi-Fi configuration and follow the instructions
 10. It will take approximately 10 minutes once connected for live updates

ALL YOU NEED TO KNOW

FAQ's

Who can install the SkyBox?

Any licensed electrician can install the SkyBox.

What is SkyCare?

SkyCare is a support team based in Victoria that you can call with any technical questions about the SkyBox. This support ensures you have an award-winning team behind you if you get stuck.

Can it charge an electric car/tractor?

Yes, you can connect the batteries to an EV charger for vehicles. Check EV compatibility and requirements beforehand.

Can the SkyBox be relocated after installation?

Yes, as the SkyBox is easy to install and uninstall, it can be relocated as required by a licensed electrician.

Can the SkyBox be installed outside?

Yes, when the door is closed and the cables are installed according to the instructions, the SkyBox carries an IP54 Rating, meaning it is weather resistant.

Can SkyBox deliver 3 Phase power?

SkyBox offers three-phase capabilities. We program everything before it leaves our warehouse, giving you easily installed, three-phase off-grid or backup power.

What's the depth of discharge of the batteries?

The Lithium batteries in the SkyBox have a 95% depth of discharge. This means you can use 95% of the battery's stored power. This is compared to the 60% usable capacity you usually get when using products like lead-acid batteries off the grid. This gives you a lot more endurance and power capacity.

HYBRID SPECIFICATIONS



AUSTRALIAN MADE

SkyBox gives everyone freedom and independence from the power grid.

Acting as a central 'brain,' the SkyBox manages incoming power from your solar, wind, or hydro generators.

Balancing these power sources and storing excess energy in the internal batteries, SkyBox creates a reliable off-grid electricity supply.

10
YEAR
★ ★ ★ ★ ★
WARRANTY

+++
EXPANDABLE



5kW



8kW

Transfer Switch
Max AC Input (A)

35A
35A

50A
50A

INVERTER

Output (V)	Output Voltage: 230VAC. Frequency 50Hz	
Rated AC Output Active Power (W)	5000W	8000W
Max AC Output Active Power (W)	5500W	8800W
Peak Power 10s (W)	6000W	12000W
Max AC Output Current (A)	21.7A	34.8A
Maximum efficiency	97.6%	97.6%

CHARGER

Max Charging Current	120	190
Max Discharging Current	120	190

SOLAR

Max PV Power*	7500W	12000W
Max Open Circuit Voltage	500V	500V
Max PV Short Circuit Current	19.5A	39A
Efficiency	99.9%	99.9%
MPPTs (Strings per Tracker)	2 (1+1)	2 (2+2)

BATTERIES

	PYLONTECH	BSLBATT
Nominal Voltage	48V	
Nominal Capacity (Wh)	4800 (Wh) multiplied by number of modules	5120 (Wh) multiplied by number of modules
Usable Capacity (Wh)	4560 (Wh) multiplied by number of modules	4966 (Wh) multiplied by number of modules
Max No. Modules	6	6
Max Capacity	PYLONTECH 28.8kWh	PYLONTECH 28.8kWh
	BSLBATT 30.72Wh	BSLBATT 30.72Wh
Working Temperature	0°C–50°C	
Design Life	10+ Years	
Cycle Life	>6000 Cycles	
Authentication Level	IEC62619/CE/UN38.3	
Warranty	10 Years to 60% retention	

MONITORING

WiFi	Yes
Ethernet	Yes

ENCLOSURE

Colour	White
Protection Category	IP54
Dimensions (h x w x d)	1072 x 1354 x 601

- * Additional Solar power can be connected, the SkyBox will only utilise the specified amount
² Size is an approximation only and may vary depending on parts available
³ Size of cabinets is an approximation only and may vary depending on stock available and size of system Off-Grid Certified meaning the SkyBox has capabilities for renewable energy and generator inputs. SkyBox creates a power supply where no grid input or referencing is required.
⁴ Subject to change.

HYBRID SPECIFICATIONS



FEATURES

Protection Built to IP54 protection standards

Standard IEC62208, IEC/EN/AS60529

Material Body: 1.5mm galvanised steel sheet
Gland Plate: 1.5mm galvanised steel sheet
Door: 1.5mm galvanised steel sheet
Device Mounting Plate: 1.5mm galvanised steel sheet
Seal: EPDM Rubber

Body The robust monoblock body is fabricated using 1.5mm galvanised steel sheet. Flat face sealing surfaces are provided to increase seal life. Pre-fitted blind nuts are incorporated to accommodate mounts and accessory fasteners to eliminate drilling and retain IP rating. Integral device plate mounts and M6 earth stud is provided.

Double Doors The robust surface mounted door is fabricated using 1.5mm galvanised steel sheet and incorporates concealed removable hinges with captive pins. The door is designed for a 110° opening. Each door contains integral cable management rail studs, M6 earth stud.

Seal Pinchweld EPDM replaceable seal

Lock 3 point locking system with key-lock swing handle.

DIMENSIONS

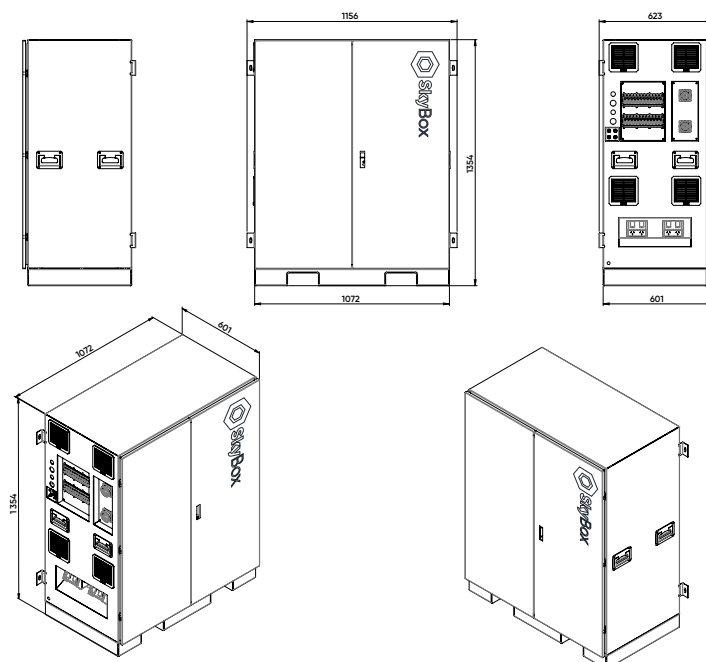



DESIGNED AND DEVELOPED BY  SkyEnergy

Sky Energy Group

4/4 Bridge Road, Keysborough,
Victoria, 3173, Australia

Tel: 1300 787 488

Email: team@skyenergysystems.com.au

Website: skyenergy.com.au

RECHARGEABLE LI-ION BATTERY US3000C

Safety Data Sheet

According to GHS (Eighth Revised Edition)

Section 1 Product and Company Identification

Product Identifier

Product Name: Rechargeable Li-ion Battery US3000C

Synonyms: -

Relevant Identified Uses of the Substance or Mixture and Uses Advised Against

Relevant Identified Uses: Please consult the manufacturer.

Uses Advised Against: Please consult the manufacturer.

Details of the Supplier of the Safety Data Sheet

Applicant Name: Pylon Technologies Co., Ltd.

Application Address: No.73, Lane 887, Zu Chongzhi Road, Zhangjiang Hi-Tech Park
Pudong, Shanghai 201203, China

Applicant Post Code: 200120

Applicant Telephone: +86-21-51317697

Applicant Fax: +86-21-51317698

Applicant E-mail: xu.min@pylontech.com.cn

Supplier Name: Pylon Technologies Co., Ltd.

Supplier Address: Plant 8, No. 505 Kunkai Road, Jinxi Town, Kunshan City, Jiangsu
Province, PEOPLE'S REPUBLIC OF CHINA

Supplier Post Code: 215300

Supplier Telephone: +86-21-51317697

Supplier E-mail: xu.min@pylontech.com.cn

Australian Importer Contact Details

Importer Names: FortePowertech P/L

Importer Address: 2/16 Ellemsea Circuit Lonsdale SA, 5160, Australia

Importer Telephone: 1300 086 898

Importer E-mail: info@fortepowertech.com.au

Section 2 Hazards Identification

Hazard class and label elements of the product according to GHS (the eighth revised edition):

GHS Hazard Class

This product meets the definition of an article. Under the Globally Harmonized System of Classification and Labeling of Chemicals (GHS), Articles as defined in the Hazard Communication Standard (29 CFR 1910.1200) of the Occupational Safety and Health Administration of the United States of America, or by similar definition, are outside the scope of the system. [Rev.8 (2019) Part 1.3.2.1.1]

GHS Label Elements

Pictogram: Not applicable.

Signal Word: Not applicable.

Hazard Statements

Not applicable.

Precautionary Statements

Prevention: Do not open or disassemble.
Do not expose to high temperatures or open fire.
Do not mix with batteries of varying sizes, chemistries or types.
Avoid using external impact battery.

Response: Not applicable

Storage: Store under the roof in cool, dry, well-ventilated areas.

Disposal: Dispose of contents/container in accordance with local/regional/national/international regulations.

Section 3 Composition/Information on Ingredients

Component	Concentration (weight percent, %)	CAS No.	EC no.
Lithium Iron Phosphate	Commercial secrets	15365-14-17	-
Graphite	Commercial secrets	7782-42-5	231-955-3
Copper	Commercial secrets	7440-50-8	231-159-6
Aluminium	Commercial secrets	7429-90-5	231-072-3
Poly (vinylidene difluoride)	Commercial secrets	24937-79-9	200-867-7
Carbon black	Commercial secrets	1333-86-4	215-609-9
Polyacrylic acid	Commercial secrets	9003-01-4	202-415-4
Lithium hexafluorophosphate	Commercial secrets	21324-40-3	244-334-7
Nickel	Commercial secrets	7440-02-0	231-111-4

Section 4 First Aid Measures

Description of First Aid Measures

General Advice

Immediate medical attention is required. Show this safety data sheet (SDS) to the doctor in attendance.

Eye Contact

Rinse thoroughly with plenty of water for at least 15 minutes and consult a physician if you feel uncomfortable.

Skin Contact

Take off contaminated clothing and shoes immediately. Wash off with plenty of water for at least 15 minutes and consult a physician if you feel uncomfortable.

Ingestion

Do not induce vomiting. Never give anything by mouth to an unconscious person. Call a physician or Poison Control Center immediately.

Inhalation

Move the victim into the fresh air. If breathing is difficult, give oxygen. Do not use mouth-to-mouth resuscitation if the victim ingested or inhaled the substance. If not breathing, provide artificial respiration and consult a physician immediately.

Protecting First-aiders

Ensure that medical personnel are aware of the substance involved. Take precautions to protect themselves and prevent the spread of contamination.

Most Important Symptoms and Effects, both Acute and Delayed

1. Substance accumulation in the human body may cause concern following repeated or long-term occupational exposure.

Indication of Any Immediate Medical Attention and Special Treatment Needed

1. Treat symptomatically.
2. Delayed symptoms may occur.

Section 5 Fire Fighting Measures

Extinguishing Media

Suitable Extinguishing Media

Dry chemical, carbon dioxide or alcohol-resistant foam.

Unsuitable Extinguishing Media

Do not use a solid water stream as it may scatter or spread the fire.

Specific Hazards Arising from the substance or mixture

1. Containers may explode when heated.
2. Fire-exposed containers may vent contents through pressure relief valves.
3. May expand or decompose explosively when heated or involved in fire.

Advice for Firefighters

1. As in any fire, wear self-contained breathing apparatus (MSHA/NIOSH approved or equivalent) and full protective gear.
2. Fight fire from a safe distance, with adequate cover.
3. Prevent fire extinguishing water from contaminating surface water or the groundwater system.

Section 6 Accidental Release Measure

Personal Precautions, Protective Equipment and Emergency Procedures

1. Ensure adequate ventilation. Remove all sources of ignition.
2. Evacuate personnel to safe areas. Keep people away from and upwind of spill/leak.
3. Use personal protective equipment. Avoid breathing vapours, mist, gas or dust.

Environmental Precautions

1. Prevent further leakage or spillage if safe to do so.
2. Discharge into the environment must be avoided.

Methods and Materials for Containment and Cleaning Up

Absorb spilled material in dry sand or inert absorbent. In case of a large amount of spillage, contain a spill by bunding.

Adhered or collected materials should be promptly disposed of in accordance with appropriate laws and regulations.

Remove all sources of ignition. Use spark-proof tools and explosion-proof equipment.

Section 7 Handling and Storage

Precautions for Handling

1. Handling is performed in a well-ventilated area.
2. Wear suitable protective equipment.
3. Avoid contact with skin and eyes.
4. Keep away from heat/sparks/open flames/hot surfaces.
5. Take precautionary measures against static discharges.

Precautions for Storage

1. Keep containers tightly closed.
2. Keep containers in a dry, cool and well-ventilated place.
3. Keep away from heat/sparks/open flames/hot surfaces.
4. Store away from incompatible materials and foodstuff containers.

Section 8 Exposure Controls/ Personal Protection

Control Parameters

Occupational Exposure Limit Values

Component	Country/Region	Limit Value - Eight Hours		Limit Value - Short term	
		ppm	mg/m ³	ppm	mg/m ³
Graphite 7782-42-5	USA - OSHA	-	15	-	-
	South Korea	-	2	-	-
	Ireland	-	10	-	-
	Germany (DFG)	-	4	-	-
	Denmark	-	2.5	-	5
	Australia	-	3 (4)	-	-
Copper 7440-50-8	The Netherlands	-	0.1	-	-
	Poland	-	0.2	-	-
	Latvia	-	0.5	-	1
	Germany (DFG)	-	0.01	-	0.02
Aluminium 7429-90-5	USA - OSHA	-	15	-	-
	South Korea	-	10	-	-
	Ireland	-	1	-	-
	Germany (DFG)	-	4	-	-
	Denmark	-	5	-	10
	Australia	-	10	-	-
Carbon black 1333-86-4	USA - OSHA	-	3.5	-	-
	South Korea	-	3.5	-	-
	Ireland	-	3.5	-	7
	France	-	3.5	-	-
	Denmark	-	3.5	-	7
	Australia	-	3	-	-
Nickel 7440-02-0	USA - OSHA	-	1	-	-
	South Korea	-	1	-	-
	Ireland	-	0.5	-	-
	Hungary	-	0.1	-	0.1
	Denmark	-	0.05	-	0.1
	Australia	-	1	-	-

Occupational Exposure Limit Values

Component	Source	Biological monitoring index	Biological limits value	Sampling time	remark
Lithium hexafluorophosphate	SCOEL(EU)	Fluorine/urine	8mg/L	end of shift	

Monitoring Methods

1. EN 14042 Workplace atmospheres. Guide for the application and use of procedures for assessing exposure to chemical and biological agents.
2. GBZ/T 160 Determination of toxic substances in workplace air (Series effective standard) and GBZ/T 300 Determination of toxic substances in workplace air (Series standard).

Engineering Controls

1. Ensure adequate ventilation, especially in confined spaces.
2. Ensure that eyewash stations and safety showers are close to the workstation location.
3. Use explosion-proof electrical/ventilating/lighting/equipment.
4. Set up an emergency exit and necessary risk-elimination area.

Personal Protection Equipment

Eye protection

Tightly fitting safety goggles approved by EN 166 (EU) or NIOSH (US).

Hand protection

Wear protective gloves (such as butyl rubber), passing the tests according to EN 374(EU), US F739 or AS/NZS 2161.1 standard.

Respiratory protection

If exposure limits are exceeded or if irritation or other symptoms are experienced, use a full-face respirator with a multi-purpose combination (US) or type AXBEK (EN 14387) respirator cartridges.

Skin and body protection

Wear fire/flame resistant/retardant clothing and antistatic boots.

Section 9 Physical and Chemical Properties

Appearance:	Li-ion battery, individually packaged, 48V 74Ah 3552Wh
Odor threshold:	No information available
Melting Point/Freezing Point (°C):	No information available
Flash Point (°C)(Closed Cup):	Not applicable
Flammability:	No information available
Vapor Pressure (KPa):	Not applicable
Relative Density (Water=1):	No information available
n-Octanol/Water Partition Coefficient:	No information available
Particle characteristics:	No information available
Odor:	No information available
pH:	No information available
Initial Boiling Point & Boiling Range (°C):	No information available
Evaporation Rate:	Not applicable
Upper/Lower explosive limits [% (v/v)]:	Upper limit: No information available; Lower limit: No information available
Relative Vapour Density (Air = 1):	Not applicable
Solubility:	No information available
Auto-Ignition Temperature (°C):	No information available
Kinematic Viscosity (mm²/s):	Not applicable

Section 10 Stability and Reactivity

Reactivity

Contact with incompatible substances can cause decomposition or other chemical reactions.

Chemical Stability

Stable under proper operation and storage conditions.

Possibility of Hazardous Reactions

Mixtures with metallic acetylene, when heated, cause a fire or incandescence. Reacts severely with halogens, interhalogens or other strong oxidants, or causes a fire. Ultrafine powder will self-ignite in the air at room temperature.

Conditions to Avoid

Incompatible materials, heat, flame and spark.

Incompatible Materials

Metal acetylide, halogen, interhalogen, halogen oxides, nitric acid, nitrous oxide, nitrates, nitrites, halogen oxyacid salts, chromates, permanganates, inorganic peroxides, metal oxides and peroxyformic acid. Halogen, interhalogen, strong oxidant, water and acids. Oxidants, halogen, interhalogen and mercury.

Hazardous Decomposition products

Under normal conditions of storage and use, hazardous decomposition products should not be produced.

Section 11 Toxicological Information

Acute Toxicity

Component	CAS No.	LD50 (Oral)	LD50 (Dermal)	LC50 (Inhalation, 4h)
Carbon Black	1333-86-4	>15400mg/kg (Rat)	>3000mg/kg (Rabbit)	No information available
Polyacrylic acid	9003-01-4	2500mg/kg (Rat)	No information available	No information available

Skin Corrosion/Irritation

No information available

Serious Eye Damage/Irritation

No information available

Skin Sensitization

No information available

Respiratory Sensitization

No information available

Germ Cell Mutagenicity

No information available

Carcinogenicity

ID	CAS No.	Component	IARC	NTP
1	15365-14-17	Lithium Iron Phosphate	Not Listed	Not Listed
2	7782-42-5	Graphite	Not Listed	Not Listed
3	7440-50-8	Copper	Not Listed	Not Listed
4	7429-90-5	Aluminium	Not Listed	Not Listed
5	24937-79-9	Poly(vinylidenedifluoride)	Not Listed	Not Listed
6	1333-86-4	Carbon black	Category 2B	Not Listed
7	9003-01-4	Polyacrylic acid	Category 3	Not Listed
8	21324-40-3	Lithium hexafluorophosphate	Not Listed	Not Listed
9	7440-02-0	Nickel	Category 2B	Not Listed

Reproductive Toxicity

No information available

Reproductive Toxicity (Additional)

No information available

STOT-Single Exposure

No information available

Aspiration Hazard

No information available

Section 12 Ecological Information

Acute Aquatic Toxicity

Component	CAS No.	Fish	Crustaceans	Algae
Nickel	7440-02-0	LC50:40mg/L (96h)(Fish)	EC50: 1mg/L (48h)	No information available
Aluminium	7429-90-5	LC50: 1.55mg/L (96h)(Fish)	No information available	No information available
Copper	7440-50-8	LC50: 0.665mg/L (96h)(Fish)	EC50: 0.02mg/L (48h)	ErC50: 79mg/L (96h)

Chronic Aquatic Toxicity

No information available.

Others

Persistence and Degradability

No information available

Bioaccumulative Potential

No information available.

Mobility in Soil

No information available

Lithium Iron Phosphate does not meet the criteria for PBT and vPvB according to Regulation (EC) No 1907/2006, annex XIII.

Graphite does not meet the criteria for PBT and vPvB according to Regulation (EC) No 1907/2006, annex XIII.

Copper does not meet the criteria for PBT and vPvB according to Regulation (EC) No 1907/2006, annex XIII.

Aluminium does not meet the criteria for PBT and vPvB according to Regulation (EC) No 1907/2006, annex XIII.

Results of PBT and vPvB Assessment

Poly(vinylidene difluoride does not meet the criteria for PBT and vPvB according to Regulation (EC) No 1907/2006, annex XIII.

Carbon black does not meet the criteria for PBT and vPvB according to Regulation (EC) No 1907/2006, annex XIII.

Polyacrylic acid does not meet the criteria for PBT and vPvB according to Regulation (EC) No 1907/2006, annex XIII.

Lithium hexafluorophosphate does not meet the criteria for PBT and vPvB according to Regulation (EC) No 1907/2006, annex XIII.

Nickel does not meet the criteria for PBT and vPvB according to Regulation (EC) No 1907/2006, annex XIII.

Section 13 Disposal Considerations

Waste Chemicals

Before disposal should refer to the relevant national and local laws and regulations. Recommend the use of incineration disposal.

Contaminated Packaging Disposal Recommendations

Containers may still present a chemical hazard when empty. Keep away from hot and ignition source of fire. Return to supplier for recycling if possible. Refer to sections 13.1 and 13.2.

Section 14 Transport Information

Transporting Label



Marine pollutant	None
UN Number	3480
UN Proper Shipping Name	Lithium ion batteries (including lithium-ion polymer batteries)
Transport Hazard Class	9
Transport Subsidiary Hazard Class	None
Packaging Group	Packagings shall conform to packing group II performance level.

Section 15 Regulatory Information

International Chemical Inventory

Component	EINECS	TSCA	DSL	IECSC	NZIoC	PICCS	KECI	AICS	ENCS
Lithium Iron Phosphate	✗	✗	✗	✗	✗	✗	✗	✗	✗
Graphite	✓	✓	✓	✓	✓	✓	✓	✓	✗
Copper	✓	✓	✓	✓	✓	✓	✓	✓	✗
Aluminium	✓	✓	✓	✓	✓	✓	✓	✓	✗
Poly(vinylidene difluoride)	✗	✓	✓	✓	✓	✓	✓	✓	✓
Carbon black	✓	✓	✓	✓	✓	✓	✓	✓	✗
Polyacrylic acid	✗	✓	✓	✓	✓	✓	✗	✓	✓
Lithium hexafluorophosphate	✓	✓	✗	✓	✗	✓	✓	✓	✗
Nickel	✓	✓	✓	✓	✓	✓	✓	✓	✗

[EINECS] European Inventory of Existing Commercial Chemical Substances.

[TSCA] United States Toxic Substances Control Act Inventory.

[DSL] Canadian Domestic Substances List.

[IECSC] China Inventory of Existing Chemical Substances.

[NZIoC] New Zealand Inventory of Chemicals.

[PICCS] Philippines Inventory of Chemicals and Chemical Substances.

[KECI] Existing and Evaluated Chemical Substances.

[AICS] Australia Inventory of Chemical Substances.

[ENCS] Existing And New Chemical Substances.

Notes

- ✓ Indicates that the substance included in the regulations
- ✗ That no data or included in the regulations

Section 16 Additional Information

Creation Date 10/10/2020

Revision Date 10/10/2020

Reason for Revision -

Disclaimer

This Safety Data Sheet (SDS) has been prepared according to UN GHS (the 8th revised edition). The data included was derived from an international authoritative database and provided by the enterprise.

Other information was based on the present state of our knowledge. We try to ensure the correctness of all information. Due to the diversity of information sources and the limitations of our knowledge, this document is only for user reference.

Users should make their independent judgement of the suitability of this information for their particular purposes. We do not assume responsibility for loss, damage or expense arising out of or in any way connected with the handling, storage, use or disposal of the product.

[illegible]

Notes

This image shows a full page of white paper with horizontal blue or grey ruling lines. The lines are evenly spaced and run across the width of the page, typical of notebook paper. There are no margins, text, or other markings on the page.

This image shows a single sheet of white paper with horizontal ruling lines. The lines are evenly spaced and run across the width of the page. There are no margins, text, or other markings on the paper.



[SKYENERGY.COM.AU/SKYBOX](https://skyenergy.com.au/skybox)

DESIGNED AND DEVELOPED BY  SkyEnergy